

**HGTC BUILDING 1400 SITE IMPROVEMENTS**  
**HGTC PROJECT #: IFB0132-18**  
**CONTRACT DOCUMENTS, TECHNICAL SPECIFICATIONS**  
**AND DRAWINGS**

**PREPARED FOR:**  
**HORRY-GEORGETOWN TECHNICAL COLLEGE**

**ADDENDUM NO. 1**

**06-15-2018**

The following items shall take precedence over the drawings and specifications for the above-named project and shall become part of the contract documents. Wherein any item is called for in the specifications, or indicated on the drawings, is not supplemented hereby, the original requirements shall remain in effect.

**LIST OF PRE-BID MEETING ATTENDEES**

The following attended the non-mandatory pre-bid meeting on June 12, 2018 at Building 1400 project site on the HGTC Campus at 10:00 am.

	<b>Name</b>	<b>Company</b>	<b>Phone Number</b>
1.	Kevin R. Brown	HGTC	843-349-5398
2.	Mark E. Stoughton Jr.	Castles Engineering	843-448-0910
3.	Jimmy Morris	Coastal Asphalt	843-240-3511
4.	Josh Burr	King Construction	704-779-2383
5.	Jerry Wiseman	R.H. Moore Co.	843-340-9563
6.	Kia Ford	Stalvey Construction Co.	843-347-9453

**CONSTRUCTION PLAN CLARIFICATIONS & REVISIONS**

The following item(s) are provided to clarify and supplement information provided in the project technical specifications:

1. A revised Standard Duty Pavement Section detail is attached (ADD. 1-1) The section shall consist of 2" Hotmix Asphalt Surface Course (SCDOT Section 403, Type C), and 6" Graded Aggregate Base Course (SCDOT Section 305).
2. A revised Edge Underdrain Detail and Pavement Underdrain Detail are attached (ADD. 1-2 and ADD. 1-3). The sections shall consist of #57 or #67 stone.

3. Regarding the anticipated demolition quantities, all bidders shall assume the existing concrete section (to be removed) is 6" thick, and the asphalt parking lot (to be removed) is 2" thick. Both sections are assumed to have been installed with 6" of GABC.

*Mark E. Stoughton P.E.*

---



End of ADDENDUM NO. 1

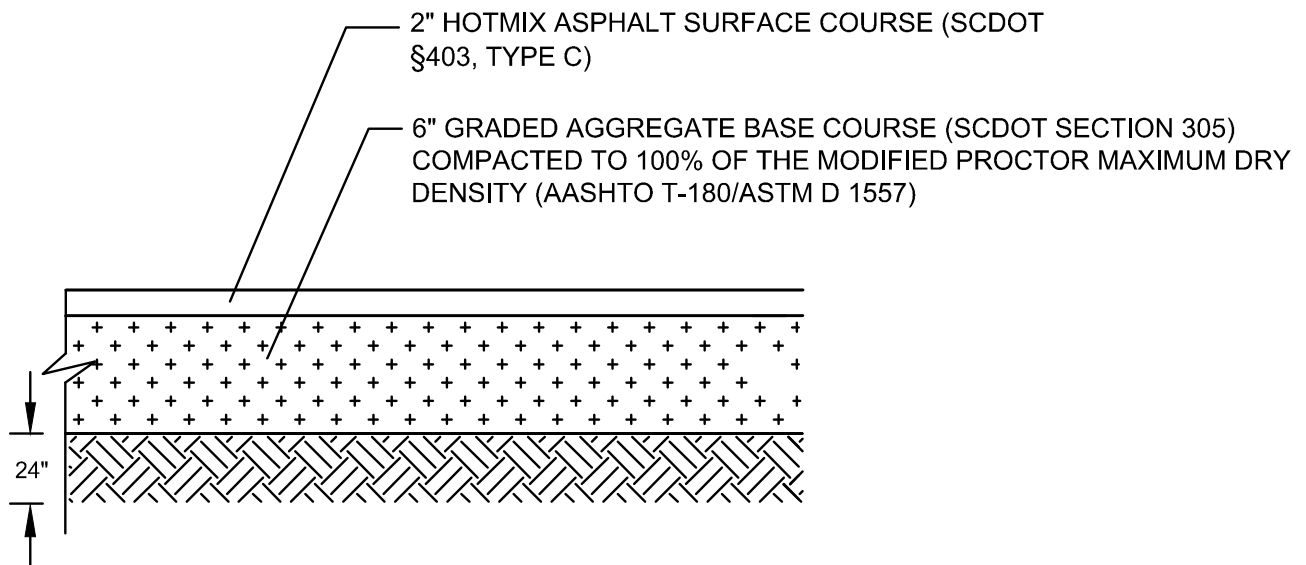

#### NOTES:

1. ALL MATERIALS SHALL MEET APPLICABLE STANDARDS SET FORTH IN THE SCDOT CONSTRUCTION STANDARDS LATEST EDITION.
2. SUBGRADE SHALL BE FREE OF ALL ROCKS AND DEBRIS LARGER THAN 1" DIAMETER AND SHALL BE COMPACTED TO 95% MODIFIED PROCTOR. CERTIFIED COMPACTION TESTS MUST BE SUBMITTED TO THE ENGINEER PRIOR TO APPLICATION OF ANY BASE MATERIAL (TO BE DETERMINED IN THE FIELD BY THE ENGINEER).
3. GABC SHALL BE COMPACTED TO 100% MODIFIED PROCTOR.
4. 24" STABILIZED SUBGRADE TO 98% OF ITS MAXIMUM DRY DENSITY IN ACCORDANCE WITH ASTM D 1557 AND AASHTO T-180.

## STANDARD DUTY PAVEMENT SECTION

### IN PARKING & DRIVE WAY AREAS



ENGINEERING / PLANNING  
LAND SURVEYING

2024 Corporate Centre Drive  
Suite 102  
Myrtle Beach, SC 29577  
Telephone: 843-448-0910  
Fax: 843-448-0969  
[www.castlesengineering.com](http://www.castlesengineering.com)

SCALE:	<b>NTS</b>
JOB NO:	<b>18.034</b>
DESIGNED BY:	<b>MES</b>
DRAWN BY:	<b>BJW</b>
CHECKED BY:	<b>MES</b>
DATE:	<b>06/15/18</b>
SHEET NUMBER:	
<b>ADD. 1-1</b>	
<b>SHEET NO. 1 OF 3</b>	

NOTES:

1. SLOPE SUBDRAIN SAME AS ROAD (UNLESS NOTED OTHERWISE) AND TIE IN TO NEAREST STORM DRAIN CATCH BASIN/CURB INLET.
2. UNDERDRAINS ARE TO BE INSPECTED PRIOR TO COVERING.
3. THE UNDERDRAINS WILL BE CONNECTED STRAIGHT INTO AND OUT OF THE CATCH BASINS. NO "T's" WILL BE ALLOWED INTO THE CATCH BASINS.
4. UNDERDRAIN IS REQUIRED IN ALL LOCATIONS SHOWN ON PLAN.

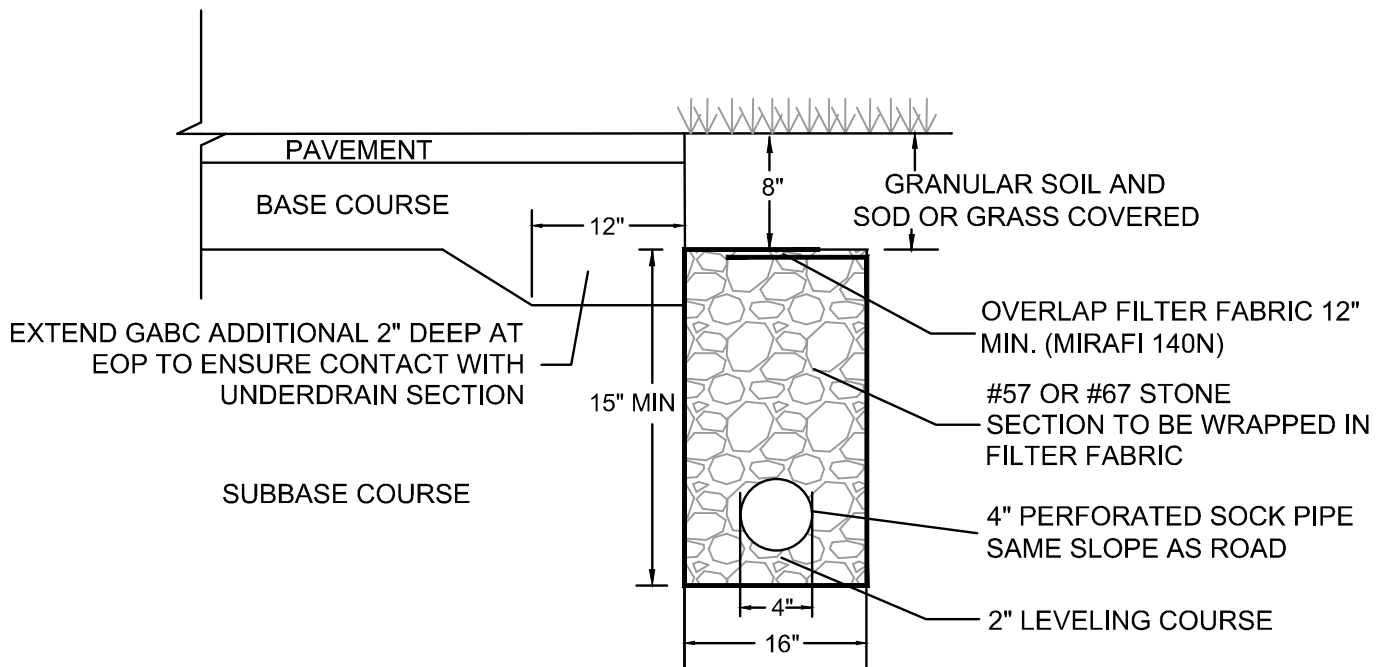

DRAIN TO RUN ENTIRE LENGTH OF DRIVEWAY  
(SEE PLANS FOR LOCATION)

## EDGE SUBDRAIN/UNDERDRAIN DETAIL

NTS



ENGINEERING / PLANNING  
LAND SURVEYING

2024 Corporate Centre Drive  
Suite 102  
Myrtle Beach, SC 29577  
Telephone: 843-448-0910  
Fax: 843-448-0969  
[www.castlesengineering.com](http://www.castlesengineering.com)

SCALE:	<b>NTS</b>
JOB NO:	<b>18.034</b>
DESIGNED BY:	<b>MES</b>
DRAWN BY:	<b>BJW</b>
CHECKED BY:	<b>MES</b>
DATE:	<b>06/15/18</b>
SHEET NUMBER:	
<b>ADD. 1-2</b>	
<b>SHEET NO. 2 OF 3</b>	

**NOTE:**

1. PIPE OUTLET SHALL BE CONNECTED INTO DRAINAGE STRUCTURES.
2. FILTER FABRIC SHALL MEET SCDOT STANDARD SPECIFICATIONS, SECTION 815.

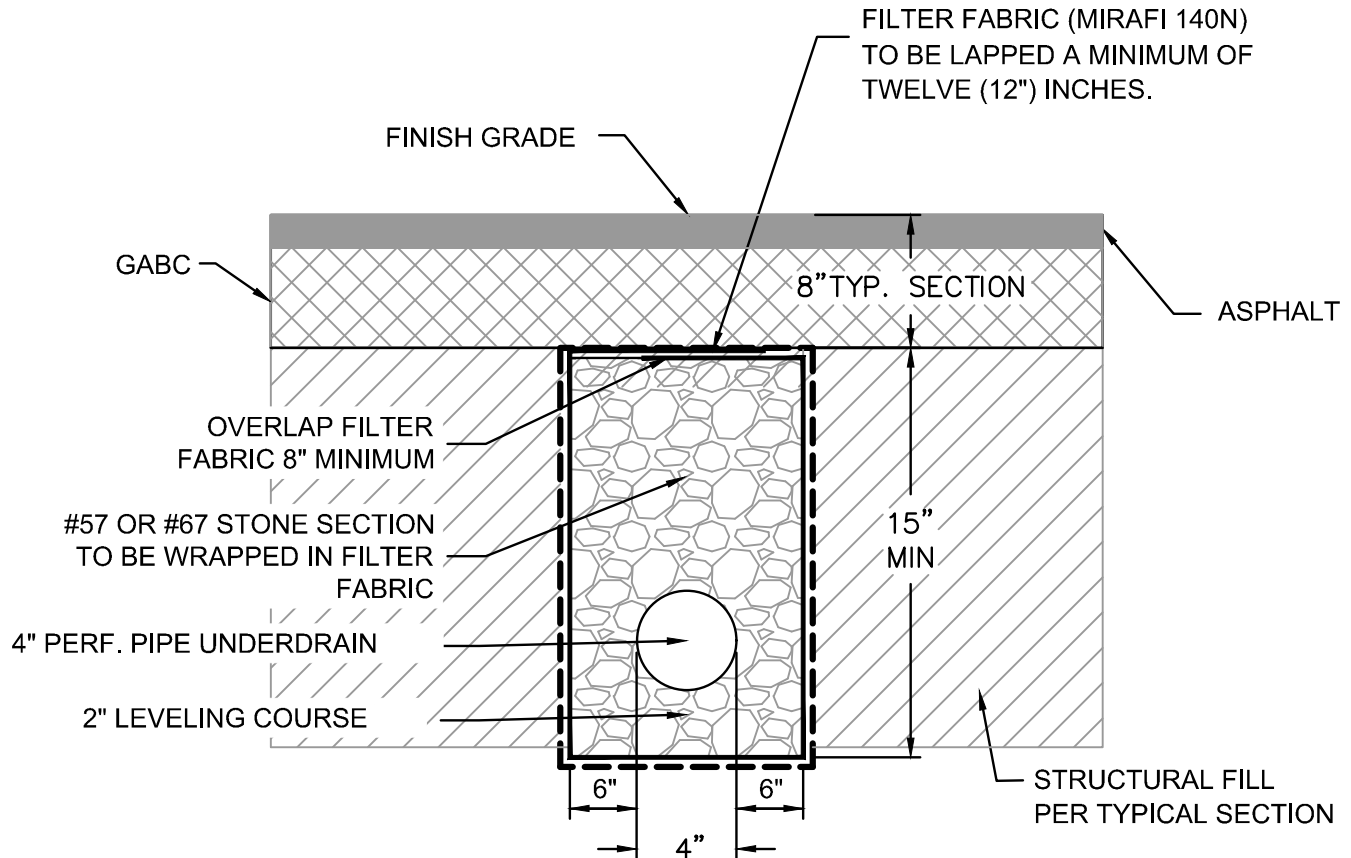

**NOTE:** THIS DETAIL SHALL BE USED DIRECTLY BENEATH THE CREASE OF THE INVERTED CROWN PARKING LOT LAYOUT. (SEE PLAN FOR LOCATION).

## PAVEMENT UNDERDRAIN

NTS



ENGINEERING / PLANNING  
LAND SURVEYING

2024 Corporate Centre Drive  
Suite 102  
Myrtle Beach, SC 29577  
Telephone: 843-448-0910  
Fax: 843-448-0969  
www.castlesengineering.com

SCALE:	NTS
JOB NO:	18.034
DESIGNED BY:	MES
DRAWN BY:	BJW
CHECKED BY:	MES
DATE:	06/15/18
SHEET NUMBER:	ADD. 1-3
	SHEET NO. 3 OF 3